

ELEMENTOS DE REGULACIÓN Y CONTROL
ELEMENTS OF REGULATION AND CONTROL

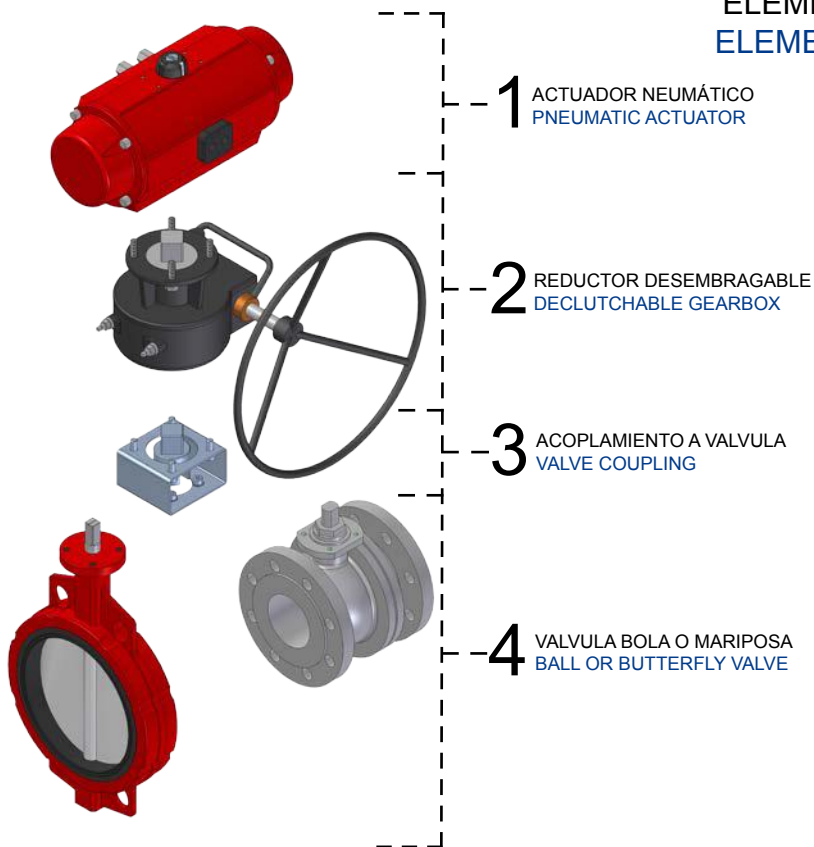

**REDUCTOR DESEMBRAGABLE
DECLUTCHABLE GEARBOX**

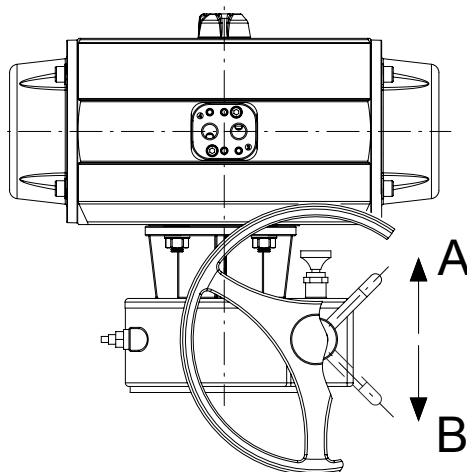

A	REDUCTOR DESEMBRAGADO UNCLUTCHED GEARBOX
B	REDUCTOR EMBRAGADO CLUTCHED GEARBOX

NOTA: No aplicable a actuadores de 180°
NOTE: Not applicable to 180° actuators

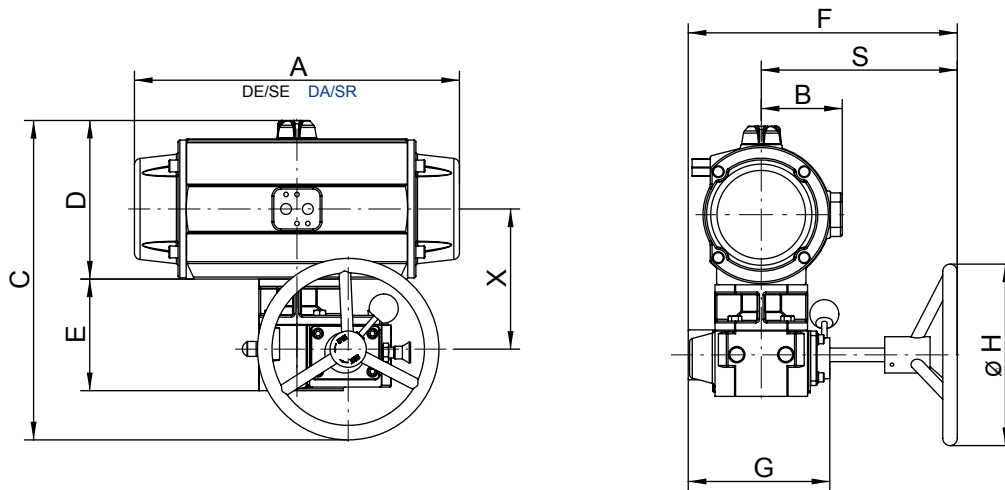

ACTUADOR ACTUATOR	REDUCTOR GEARBOX	INSTALACION INSTALLATION	DIMENSIONES (mm)								DIMENSIONS (mm)		
			A		B	C	D	E	F	G	S	H	X
DE/DA	SE/SR												
PA00-PA00S	RD-415	IRD-41500	155		52	263	102	118	236	118	173	150	130
PA05-PA05S		IRD-41510	201		62	280	119						136
PA10-PA10S			226		63	284	123						139
PA15-PA15S		265		71	300	139	147						
PA20-PA20S	RD-420	IRD-42020	312		75	337	147	122	241	142	170	200	155
PA25-PA25S		IRD-42025	358		89	365	175						168
PA30-PA30S	RD-330		IRD-33025				413		145	370	210	280	300
		IRD-33030	429		97	430	191	175					
P40-P40S	RD-345	IRD-34540	444	598	120	569	272	162	396	243	286	400	213
P50-P50S		RD-350	IRD-34550	524		694	135						610
	IRD-35050					725		175	459	267	348	600	245
PA60-PA60S	RD-360	IRD-36050	672		172	780	368						194
		IRD-36060				865		284					
PA70-PA70S	RD-370	IRD-36070				925	428	209	628	337	468	800	313
		IRD-37070	743		216	955							318

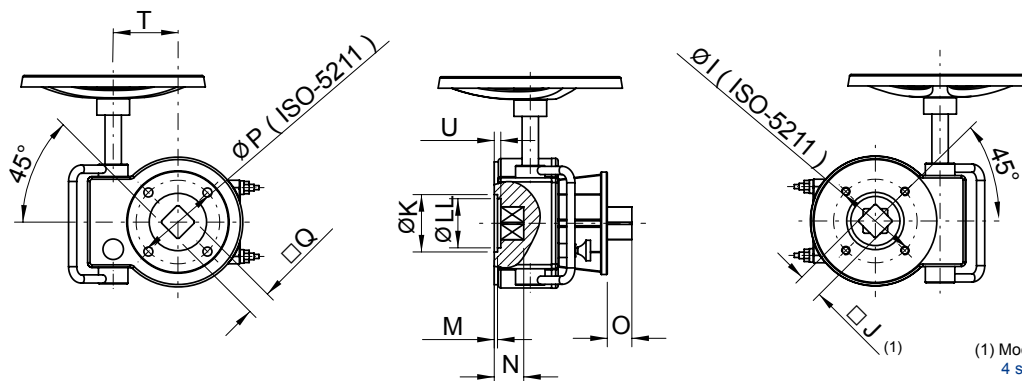

(1) Modelo serie 4 estrella
4 series star

DIMENSIONES DEL REDUCTOR
GEARBOX DIMENSIONS

REDUCTOR GEARBOX	LADO ACTUADOR ACTUATOR SIDE				LADO VALVULA VALVE SIDE							Peso* Weight*	PAR Torque (Nm)	
	ISO-5211		■ Q	T	ISO-5211		■ J	U	K	LL	M			N max.
	STAND.	OPTION			STANDARD	OPTION								
RD-415	F05-F07	-	17	45	F05-F07	-	17	6,5	35	30	2	35	4,4 Kg	125
RD-420	F07	-	17	50	F07-F10	-	17	6	55	38	3	35	7,4 Kg	270
RD-330	F07-F10-F12	-	34 max.	68	F07-F10-F12	-	27 max.	-	60	-	6	58	17 Kg	750
RD-345	F12	F10-F14	48 max.	88	F14	F10-F12	34 max.	-	75	-	4	66	21 Kg	1450
RD-350	F14	F12-F16	52 max.	115	F14	F10-F12-F16	36 max.	-	88	-	5	71	34 Kg	2485
RD-360	F16	F14	62 max.	137	F16	F12/F14	46 max.	-	102	-	7	92	54 Kg	3390
RD-370	F16-F25	-	65 max.	165	F16-F25	-	55 max.	-	130	-	6	113	80 Kg	7450

(*) Excluidos los volantes
(* Excluded handwheels)